

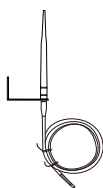

**iVision+ Connect**



External antenna **IVPC-ANT**

for Wi-Fi communication only.  
(Sub 1 GHz IVPC-DI range will not be affected.)

## Introduction

This guide covers the installation of the external antenna optional accessory for the IVPC-DS.

The external antenna comes with a 5 feet cable to allow for greater flexibility in antenna placement.

The guide will cover some key considerations for optimal placement of the antenna.

## General Information

The IVPC-ANT helps by providing an antenna at a position that avoids obstacles against radio waves such as walls and doors. The best communication is achieved by a direct open path between the communicating devices, in this case the Wi-Fi router and the IVPC-DS. The antenna will not boost signal strength. If the Wi-Fi signal is too weak at the IVPC-DS location, please consider getting a Wi-Fi range extender.

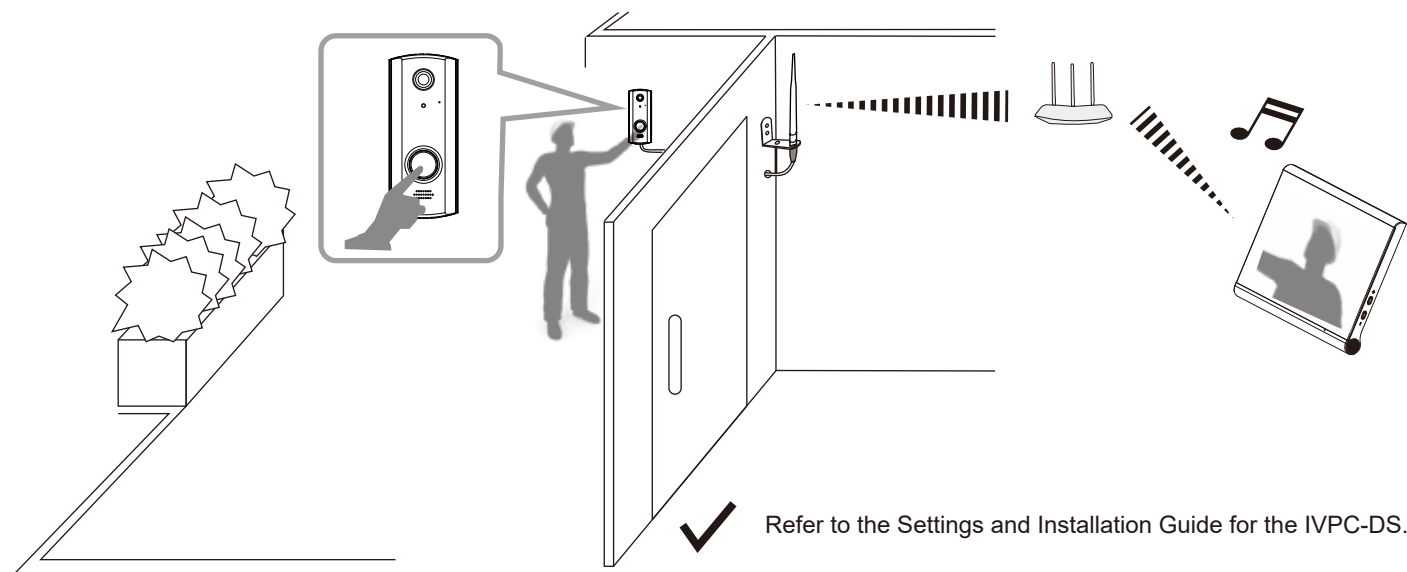

Refer to the Settings and Installation Guide for the IVPC-DS.



Do not use any external antenna other than the IVPC-ANT.  
Do not extend the antenna and connecting cables.  
(The cable and antenna are matched for optimal performance.)

## Parts identifications

Bracket and cable  
l = 1.5 m (5 ft.)

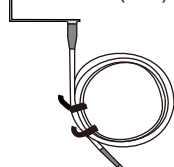

Antenna



Connecting cable  
l = 0.2 m (7.9 inch)

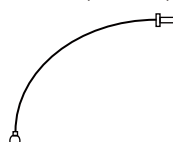

## < Accessories >

Screws & anchors



## What to expect

- 1 **Important points to consider**; read to avoid multiple installation attempts.
- 2 **Preparation on the IVPC-DS**; steps to take before mounting.
- 3 **Mounting**; how to mount the IVPC-ANT.
- 4 **Confirm operation**; make sure everything is working.

## 1 Important points to consider

1. Activate the IVPC-DS and check the signal strength indicator using the IVPC-MS or a device running the OPTeX Vision App. This will be your reference level.
2. The IVPC-DS can be unmounted and brought to the intended antenna install location for Wi-Fi range checking before attaching the antenna. This is useful for assessing your Wi-Fi environment.

## 2 Preparation on the IVPC-DS

1 Loosen the lock screw.

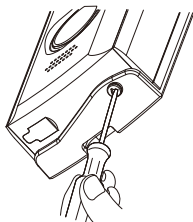

2 Remove the main unit.

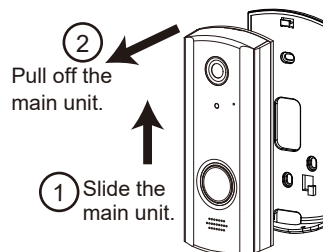

3 Remove the front cover.

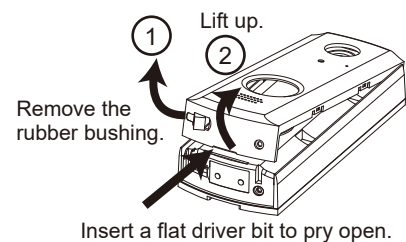

4 Power off.

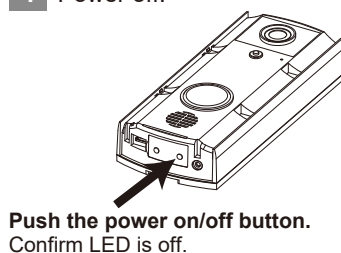

5 Remove the back cover.

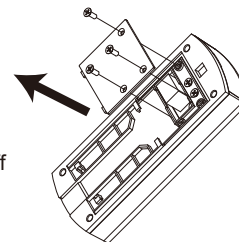

### Caution

- If hardwired, please turn off power to the device while the terminals are exposed.

6 Switch from INT to EXT of the internal/external antenna switch.

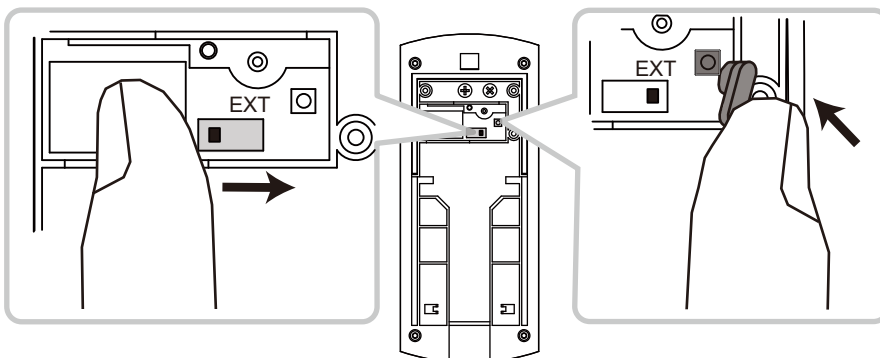

7 Attach the connecting cable.

8 Replace the back cover.

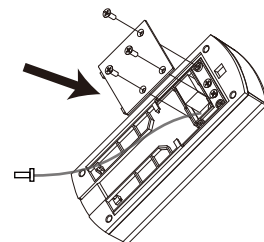

### Caution

- The back cover protects against water intrusion. Make sure nothing is interfering with it.

**9** Power on.

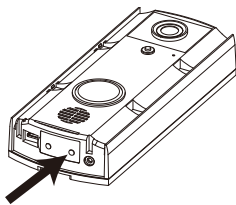

Push the power on/off button.

**10** Replace the front cover.

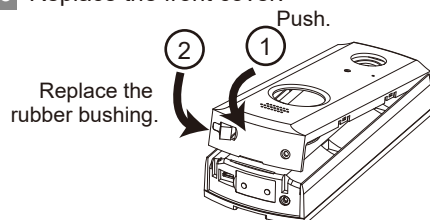

If having trouble with the cover, make sure the bushing is not in the way.

**11** Push the front cover to secure.

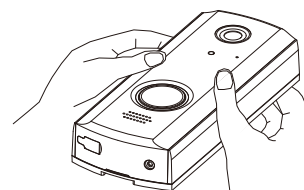

**12** Mount the main unit.

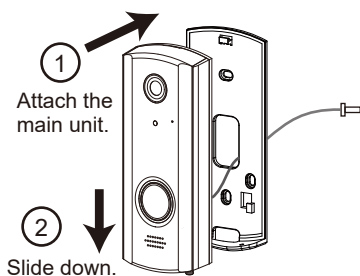

**13** Tighten the lock screw.

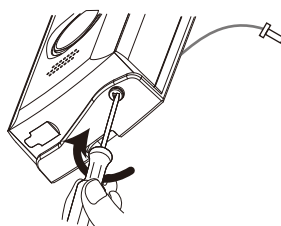

### 3 Mounting

**1** Mount the bracket and set the antenna.

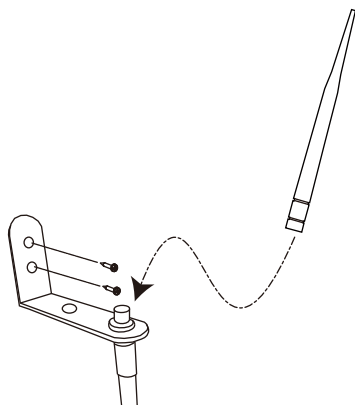

**2** Run the cables.

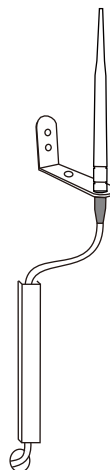

**3** Connect cables.

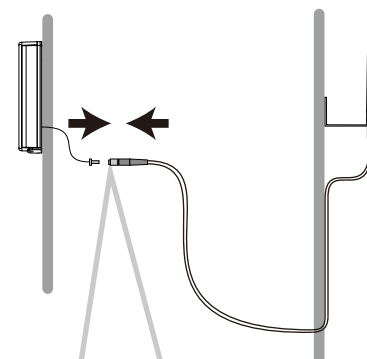

**NOTE** Consider waterproof treatment as necessary.

### 4 Confirm operation

- Do a test run to check whether the signal strength is enough.
- Push the doorbell button on the IVPC-DS and confirm audio and video on the IVPC-MS or the OPTEX Vision App.
- Hand this guide and the user manual to the end user for safekeeping.

<< Troubleshooting >> Additional troubleshooting available online at URL; [optexamerica.com/faq](http://optexamerica.com/faq)

Status	Check point	Solution
The signal has not improved.	Check that the internal/external antenna switch is properly set to EXT. Check that the antenna is properly connected to the back of the IVPC-DS port	Switch to EXT of the internal/external antenna switch of the IVPC-DS. Attach the connecting cable of the IVPC-ANT so it is firmly on the port.
The Wi-Fi signal is intermittent.	Check if other devices are showing Wi-Fi issues. Check if something has changed in the environment to interfere with the signal.	Check for Wi-Fi coverage using the IVPC-DS, IVPC-MS or device running the OPTEX Vision App. Move the Wi-Fi router closer to the IVPC-DS or use a range extender.

**NOTE**

- Test the total operation after the installation completed.
- Dispose of used products should be in accordance with local government regulations/laws.



OPTEX CO., LTD. (JAPAN)  
URL: [www.optex.net](http://www.optex.net)

OPTEX INC. (U.S.)  
URL: [www.optexamerica.com](http://www.optexamerica.com)

p. 800-966-7839  
[warranty-returns@optexamerica.com](mailto:warranty-returns@optexamerica.com)  
[tech@optexamerica.com](mailto:tech@optexamerica.com)



**Video and FAQ available:**  
[optexamerica.com/resource/ivision-connect](http://optexamerica.com/resource/ivision-connect)

Copyright (C) 2019 OPTEX CO.,LTD.